



GANDUS UNICA V– VV

ISO 11607.2 VALIDATABLE PNEUMATIC IMPULSE SEALERS

TRACEABILITY FROM EXTERNAL NETWORK

7" COLOUR TOUCH SCREEN AND REMOTE SETTING

VIA APP WITH NO CABLE CONNECTIONS

VENTURI AIR SUCTION SYSTEM

TOP PERFORMANCE IN LIFE SCIENCE

IN THE LIFE SCIENCE SECTOR, WHERE QUALITY, CONTROL, AND TRACEABILITY ARE NON-NEGOTIABLE REQUIREMENTS, SEALING TECHNOLOGY PLAYS A CENTRAL ROLE.

THE **UNICA** SERIES WAS DEVELOPED TO MEET THE MOST DEMANDING APPLICATIONS, OFFERING PNEUMATIC IMPULSE HEAT-SEALING SOLUTIONS (COMBINED WITH VACUUM FUNCTIONS WITH UNICA VACUUM), DESIGNED TO ENSURE HIGH PERFORMANCE, MAXIMUM PROCESS RELIABILITY, FULL COMPLIANCE WITH THE MOST STRINGENT REGULATORY STANDARDS.

A RANGE CONCEIVED TO DELIVER THE HIGHEST LEVEL OF OPERATIONAL EXCELLENCE.

KEY TECHNICAL FEATURES

7" TOUCHSCREEN CONTROL AND REMOTE MANAGEMENT VIA APP, WITHOUT CONNECTION CABLES

AISI 304 STAINLESS STEEL CONSTRUCTION

DOUBLE SEALING BAR

FLAT IMPULSE SEALING

SEALING LENGTHS: MM 610, MM 810, MM 1010, MM 1210

SEALING WIDTH: MM 8

ISO 11607.2 VALIDATABLE

VENTURI AIR EXTRACTION SYSTEM WITH ONE ADJUSTABLE-POSITION NOZZLE TO ENSURE MAXIMUM PERFORMANCE (UNICA VACUUM)

FOOT PEDAL ACTIVATION INCLUDED

SEALABLE MATERIALS: DESIGNED AND MANUFACTURED FOR ALL HEAT-SEALABLE MATERIALS USED IN MEDICAL, PHARMACEUTICAL, LABORATORY, AND CHEMICAL INDUSTRY APPLICATIONS

APPLICATIONS

DESIGNED FOR ALL HEAT-SEALABLE MATERIALS, WHICH GENERALLY FINDS APPLICATION IN MEDICAL, PHARMACEUTICAL, LIFE SCIENCE, LABORATORY AND CHEMICAL INDUSTRY.

GANDUS UNICA V - VV

TOP PERFORMANCE IN LIFE SCIENCE

WHY CHOOSE UNICA. DISCOVER THE ADVANTAGES OF TECHNOLOGICAL EXCELLENCE

MAXIMUM PRECISION, CONTROL, AND PROCESS QUALITY

COMPLETE CONTROL OF ALL CRITICAL SEALING PARAMETERS ENSURES RELIABLE AND REPEATABLE VALIDATION.

RELIABLE PERFORMANCE EVEN IN EXTREME INDUSTRIAL ENVIRONMENTS

AISI 304 STAINLESS STEEL STRUCTURE DESIGNED FOR HIGH PERFORMANCE AND LONG SERVICE LIFE.

ADVANCED OPERATIONAL CONTROL

7" FULL-COLOR HMI TOUCHSCREEN INTERFACE WITH LOCAL AND REMOTE MANAGEMENT VIA APP, VNC, AND EASY ACCESS, WITHOUT THE NEED FOR WIRED CONNECTIONS. FOR COMPLETE AND CONTINUOUS PROCESS MONITORING.

INTELLIGENT, ADJUSTABLE, AND CONTROLLED VACUUM EXTRACTION (UNICA VACUUM)

VENTURI-TYPE AIR EXTRACTION SYSTEM EQUIPPED WITH AN ADJUSTABLE NOZZLE (POSITION AND LENGTH), DESIGNED TO ENSURE HIGHLY PRECISE, CONTROLLED, AND REPEATABLE VACUUM PERFORMANCE ON BAGS OF ANY SIZE AND WITH DIFFERENT FILLING LEVELS.

DIAGNOSTICS AND FAULT MANAGEMENT SYSTEM

MINIMIZED DOWNTIME.

REAL-TIME DIAGNOSTICS AND MONITORING SYSTEM AVAILABLE VIA HMI AND REMOTE ACCESS, WITH ALARM HISTORY FOR ANALYSIS AND PREVENTIVE MAINTENANCE.

OPTIMIZED OPERATOR INTERFACE

HMI SOFTWARE DESIGNED ACCORDING TO INDUSTRIAL USABILITY CRITERIA FOR FAST, INTUITIVE, AND EFFICIENT OPERATION.

GANDUS UNICA V - VV

TOP PERFORMANCE IN LIFESCIENCE

WHY CHOOSE UNICA. DISCOVER THE ADVANTAGES OF TECHNOLOGICAL EXCELLENCE

HIGH FLEXIBILITY IN PRODUCTION CONFIGURATION

MANAGEMENT OF UP TO 64 PRESET RECIPES AND QUICK CONFIGURATION FOR DIFFERENT PRODUCTS, ENSURING MAXIMUM OPERATIONAL ADAPTABILITY AND REDUCED SETUP TIMES.

PROCESS TRACEABILITY AND REGULATORY COMPLIANCE

INTEGRATED AUDIT TRAIL SYSTEM WITH DATA MANAGEMENT AND EXCHANGE VIA LAN NETWORK, USB, AND MODBUS TCP/IP OR OPC/UA PROTOCOLS, SUPPORTING QUALITY REQUIREMENTS.

CENTRALIZED MULTI-PLANT MANAGEMENT

REMOTE CONTROL ARCHITECTURE FOR COORDINATED MANAGEMENT OF MULTIPLE MACHINES AND SYSTEMS LOCATED IN DIFFERENT FACILITIES.

INTEGRATION WITH AUTOMATION AND CORPORATE IT SYSTEMS

STANDARD INTERFACING VIA LAN NETWORK AND INDUSTRIAL COMMUNICATION PROTOCOLS: MODBUS TCP/IP, OPC/UA, VNC.

ADVANCED CONFIGURABILITY AND ERGONOMICS

ADJUSTABLE TABLE HEIGHT, TILT, AND POSITION, WITH OPTIONAL MECHANICAL OR MOTORIZED SUPPORT FOR OPTIMAL ERGONOMICS.

Services supporting long-term performance

Val Pack (IQ and OQ) and optional services dedicated to maintaining performance, reliability, and operational continuity.

GANDUS UNICA V - VV

TOP PERFORMANCE IN LIFE SCIENCE

NEW HARDWARE AND SOFTWARE IMPLEMENTATIONS (OPTIONAL UPON REQUEST)

AUDIT TRAIL

TO CHRONOLOGICALLY AND THOROUGHLY DOCUMENT ALL ACTIVITIES OR CHANGES, CRUCIAL FOR ENSURING SECURITY, REGULATORY COMPLIANCE, TRANSPARENCY, AND EFFECTIVE INTERNAL CONTROLS.

VACUUM SENSOR WITH DUAL OPERATING MODES:
TIME SETTING OR VACUUM LEVEL SETTING

COMMUNICATION STANDARD: OPC-UA SERVER

SKIP FUNCTION FOR THE VACUUM AND/OR GAS INJECTION PHASE

VERSIONS

UNICA V – VALIDABLE PNEUMATIC IMPULSE SEALER

UNICA VV – VALIDABLE PNEUMATIC IMPULSE SEALER WITH VACUUM/GAS FLUSHING OPTION

BENCH-TOP VERSION

COMPLETE WITH MOTORIZED OR MECHANICAL SUPPORT VERSION

VERSION DESIGNED FOR INTEGRATION INTO COMPLETE PACKAGING LINES

AVAILABLE SIZES: 610 MM – 810 MM – 1010 MM – 1210 MM

COMPLIANCE

UNI EN ISO 11607.2

UNI EN 868-5:2019

EN ISO TS 16775

DIN 58953-7

DIRECTIVES 2006/42/EC – 2014/30/EU – 2014/35/EU

UNI/TR 11408:2011

STERILIZATION GUIDELINES – MEMO 5

EU GMP ANNEX 1: MANUFACTURE OF STERILE MEDICINAL PRODUCTS

MANUFACTURED IN A COMPANY CERTIFIED WITH A QUALITY MANAGEMENT SYSTEM UNI EN ISO 9001:2015

VALIDATION TESTS AND SERVICES

GANDUS SALDATRICI OFFERS A RANGE OF VALIDATION TESTS AND SERVICES TO ENSURE SAFE AND RELIABLE DAILY CONTROL OF MEDICAL HEAT SEALERS FOR STERILIZATION POUCHES, IN ACCORDANCE WITH ISO 11607.1/2 AND ASTM F1929 STANDARDS.

PACKAGING MATERIALS

THE MATERIALS DIVISION OF GANDUS SALDATRICI OFFERS THE BEST TYPES OF PE AND VACUUM POUCHES AND BAGS, SELECTED TO ENSURE MAXIMUM PRODUCT PROTECTION AND PERFECT INTEGRATION WITH UNICA MACHINES.

MATERIALS ARE AVAILABLE FROM STOCK IN DIFFERENT SIZES OR CAN BE SUPPLIED ON REQUEST.

AVAILABLE PLAIN, WITH CENTRAL WHITE STRIP, OR WITH CUSTOMIZED PRINTING.

THE MOST EFFICIENT WAY TO ACHIEVE HIGHEST STANDARDS OF OPERATIONAL EFFICIENCY, COST REDUCTION, AND PACKAGING QUALITY.

GANDUS UNICA V - VV

TOP PERFORMANCE IN LIFE SCIENCE

DIFFERENT SETTINGS TO MATCH ALL MOST SPECIFIC PACKAGING REQUIREMENTS

ADJUSTABLE WORKING HEIGHT



ADJUSTABLE WORKING INCLINATION

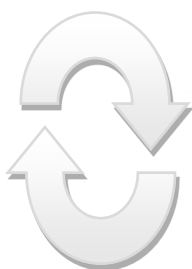

ADJUSTABLE TABLE POSITION

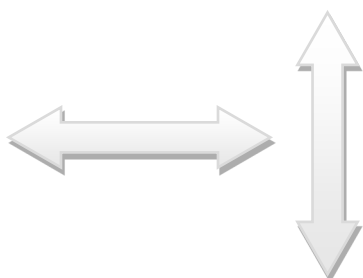

GANDUS UNICA V - VV

TOP PERFORMANCE IN LIFE SCIENCE

TOUCH SCREEN PANEL

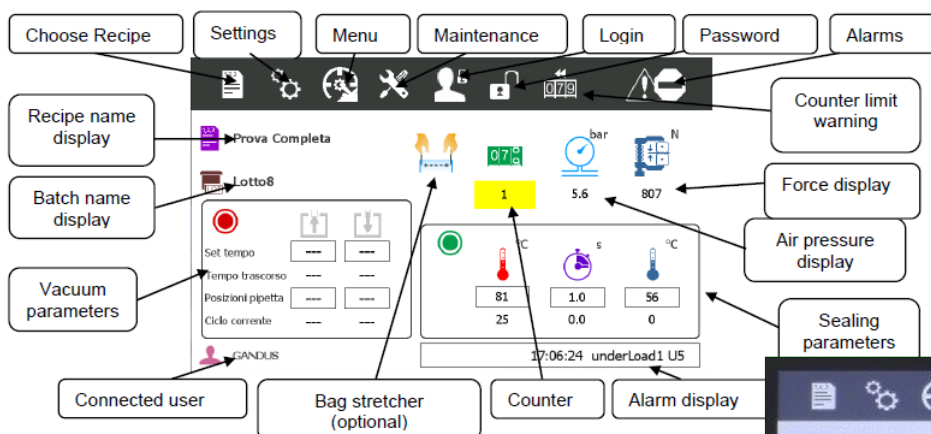

VACUUM NOZZLE

THE VENTURI AIR SUCTION SYSTEM WORKS WITH A SPECIAL MOTORIZED WITH ENCODER NOZZLE, THAT CAN BE SET IN DIFFERENT POSITIONS, ACCORDING TO THE MOST SPECIFIC PACKAGING REQUIREMENTS. AISI 316L STAINLESS STEEL CONSTRUCTION. DOUBLE POSITION SETTING FOR SUCTION PIPETTE. POSSIBILITY OF SUCTION / GAS FLUSHING IN RETRACTION. UP TO 6 SUCTION/FLUSHING CYCLES.



GANDUS UNICA V

VALIDATABLE PNEUMATIC IMPULSE SEALER

TOP PERFORMANCE IN LIFESCIENCE

TECHNICAL FEATURES

MODEL	UNICA 610 V / UNICA 810 V / UNICA 1010 V/ UNICA 1210 V
MATERIALS	SEALABLE PAPER POUCHES ACCORDING TO EN ISO 11607-1/EN 868-4 SEALABLE POUCHES AND REELS ACCORDING TO EN ISO 11607-1/EN 868-5 MADE OF FILM AND PAPER ACCORDING TO EN 868-3 SEALABLE POUCHES AND REELS ACCORDING TO ISO EN 11607-1/EN 868-5 MADE OF FILM AND UNCOATED MATERIALS MADE OF POLYOLEFINS ACCORDING TO EN 868-9 (E.G. TYVEK [®]) SEALABLE POUCHES AND REELS ACCORDING TO ISO 11607-1/EN 868-5 MADE OF PP FLEECE OR PP NONWOVEN PEELABLE POUCHES PA/PE BAGS MADE OF THERMOPLASTIC MATERIALS, HEADER BAGS (PP, PE, PVC), PEELABLE FILMS IN PA/PE, LAMINATES INCLUDING ALUMINUM LAMINATES
SEALING LENGTH	UNICA 610 V -610 MM UNICA 810 V -810 MM UNICA 1010 V - 1010 MM UNICA 1210 V - 1210 MM
SEALING HEIGHT	8 MM
KIND OF SEALING	FLAT SEALING - DOUBLE SEALING BAR
ARCHITECTURE HARDWARE	ROPEX RES 5009 + GANDUS EMBEDDED BOARD + HMI COLOUR TOUCH SCREEN 7"
EXTERNAL CONNECTIONS	1 RJ45 (ETHERNET) PORT, 1 USB PORT, 1 RS232 PORT,
CYCLE START COMMAND	VIA ELECTRIC PEDAL
SOFTWARE LOGIC	INTUITIVE ICON-BASED MENU
FUNCTIONING	ELECTRIC / PNEUMATIC
CONSTRUCTION	AISI 304 STAINLESS STEEL AND ALUMINIUM - AISI 304 STAINLESS STEEL FRAME
POWER	230 V – 1PH – 50/60HZ 115 V – 1PH – 50/60HZ
MAX POWER CONSUMPTION	UNICA 610 V - 1400 W UNICA 810 V - 1800 W UNICA 1010 V - 2100 W UNICA 1210 V - 2400 W
PNEUMATIC	0.6 MPA (6 BAR)
ACOUSTIC EMISSION LEVEL	< 70 dB(A)
PACKAGING STANDARDS	ISO 11607-2:2020 / ISO / TS 16775 / EN 868-5:2019 / DIN 58953-7
DIMENSIONS WxDxH	UNICA 610 V -730x600x280 MM; UNICA 810 V -930x600x280 MM UNICA 1010 V -> 1130x600x280 MM; UNICA 1210 V -> 1230x600x280 MM
WEIGHT (WITHOUT ACCESSORIES)	UNICA 610 V -51 KG; UNICA 810 V -53 KG UNICA 1010 V - 56 KG; UNICA 1210 V - 58 KG

GANDUS UNICA V

VALIDATABLE PNEUMATIC IMPULSE SEALER

TOP PERFORMANCE IN LIFE SCIENCE

TECHNICAL FEATURES

MACHINE SETTINGS	HMI REMOTE ACCESS AND MANAGEMENT VIA VNC DATA EXCHANGE IN/OUT THROUGH PROTOCOL MODBUS TCP/IP	
RECIPES	NUMBER NAME	64 RECIPES 20 ALPHANUMERIC CHARACTERS
OPERATORS	NUMBER NAME	40 OPERATOR NAMES WITH ADJUSTABLE ACCESS LEVELS AND PASSWORDS 20 ALPHANUMERIC CHARACTERS
BATCH	NUMBER NAME	40 CODICI BATCH ALFANUMERICI 20 ALPHANUMERIC CHARACTERS
RECIPES / OPERATORS / BATCH	SAVING	THROUGH HMI IN/OUT VIA LAN NET AND COMMUNICATION PROTOCOL MODBUS TCP/IP IN/OUT VIA USB PENDRIVE
	SEALING TEMPERATURE RANGE TOLERANCE RANGE	40 – 220 °C +/- 5 °C
	SEALING FORCE RANGE	750 – 1050 N
PROCESS PARAMETERS	SEALING TIME RANGE COOLING RANGE	0 – 20 s 40 – 220 °C
WORKING CYCLES COUNTER	MODE	INCREASING AFTER COUNTING SETTING DECREASING AFTER COUNTING SETTING UNLIMITED STOP AFTER COUNTING RESTART AFTER COUNTING
BUZZER	MODE	GENERAL SOUNDS OR ALARMS ONLY
LANGUAGE	MODE	MULTILANGUAGE MENU (ITALIAN, ENGLISH, OTHER LANGUAGES AVAILABLE)

E&OE
TECHNICAL MODIFICATIONS RESERVED 02/2026

GANDUS UNICA V

VALIDATABLE PNEUMATIC IMPULSE SEALER

TOP PERFORMANCE IN LIFESCIENCE

TECHNICAL FEATURES UNICA V

CALIBRATION	CALIBRATION	SEALING TEMPERATURE
	PARAMETERS CONTROL (STOP WITH ALARM)	SEALING TEMPERATURE SEALING TIME SEALING FORCE POWER AIR PRESSURE TRACEABILITY ANOMALIES DIAGNOSTIC ANOMALIES
VALIDATION & TRACEABILITY	MACHINE ONBOARD USB PEN DRIVE EXTERNAL NETWORK	MACHINE ID SEALING TEMPERATURE SEALING TIME SEALING FORCE COOLING TEMPERATURE OPERATOR (USER) BATCH DATE HOUR POUCH NUMBER FIRMWARE AND SOFTWARE VERSIONS ERROR
MACHINE LOCK FUNCTIONS	LOGIN LEVELS MACHINE LOCK / UNLOCK ALARM HISTORY	2 GENERAL ACCESS LEVELS WITH PASSWORD LOGIN WITH BARCODE SCANNER (OPTION) POSSIBLE FOR ACCESS LEVELS DATE/HOUR ALARM CODES/ALARM DESCRIPTIONS
MACHINE FUNCTIONS	COUNTERS	MACHINE GENERAL COUNTERS AND MAINTENANCE ALARM

E&OE
TECHNICAL MODIFICATIONS RESERVED 02/2026

GANDUS UNICA V

VALIDATABLE PNEUMATIC IMPULSE SEALER

TOP PERFORMANCE IN LIFESCIENCE

CONFORMITIES

DIRECTIVES	2006/42/CE 2014/30/UE 2014/35/UE 2015/863/EU
REFERENCES	UNI EN ISO 11607-2 UNI EN 868-5 EN ISO TS 16775 DIN-58953 7 DIRECTIVES 2006/42/EC-2014/30/UE-2014/35/UE UNI/TR 11408 STERILIZATION GUIDELINES-MEMO 5 EU GMP ANNEX 1: MANUFACTURE OF STERILE MEDICINAL PRODUCTS PRODUCED IN A COMPANY CERTIFIED WITH UNI EN ISO 9001:2015 QUALITY SYSTEM

ACCESSORIES

FLOOR STAND	AISI 304 STAINLESS STEEL AND ALUMINIUM CONSTRUCTIONX, MOTORIZED, ADJUSTABLE HEIGHT AND INCLINATION, WHEELED
HORIZONTAL WORKING TABLE	ADJUSTABLE IN HEIGHT HORIZONTAL WORKING TABLE – AVAILABLE ONLY WITH FLOOR STAND
INCLINED WORKING TABLE	ADJUSTABLE IN INCLINATION WORKING TABLE – AVAILABLE ONLY WITH FLOOR STAND
BAG STRETCHER	OPEN MOUTH BAG STRETCHER
CUTTING DEVICE	BAG TRIMMER
PRINTING DEVICE	LABEL PRINTER
SCANNER	BARCODE SCANNER
VALIDATION SERVICES	IQ/OQ PEEL TEST DYE TEST SEAL CHECK CALIBRATION
NEW HARDWARE AND SOFTWARE IMPLEMENTATIONS (OPTIONAL UPON REQUEST)	AUDIT TRAIL OPTIONAL VACUUM SENSOR WITH DUAL OPERATING MODES: TIME SETTING OR VACUUM LEVEL SETTING SKIP FUNCTION FOR THE VACUUM AND/OR GAS INJECTION PHASE COMMUNICATION STANDARD: OPC-UA SERVER

E&OE
TECHNICAL MODIFICATIONS RESERVED 02/2026

GANDUS UNICA VV

VALIDATABLE PNEUMATIC IMPULSE SEALER WITH VACUUM/GAS FLUSHING OPTION

TOP PERFORMANCE IN LIFE SCIENCE

TECHNICAL FEATURES

MODEL	UNICA 610 VV / UNICA 810 VV / UNICA 1010 VV/ UNICA 1210 VV
MATERIALS	SEALABLE PAPER POUCHES ACCORDING TO EN ISO 11607-1/EN 868-4 SEALABLE POUCHES AND REELS ACCORDING TO EN ISO 11607-1/EN 868-5 MADE OF FILM AND PAPER ACCORDING TO EN 868-3 SEALABLE POUCHES AND REELS ACCORDING TO ISO EN 11607-1/EN 868-5 MADE OF FILM AND UNCOATED MATERIALS MADE OF POLYOLEFINS ACCORDING TO EN 868-9 (E.G. TYVEK®) SEALABLE POUCHES AND REELS ACCORDING TO ISO 11607-1/EN 868-5 MADE OF PP FLEECE OR PP NONWOVEN PEELABLE POUCHES PA/PE BAGS MADE OF THERMOPLASTIC MATERIALS, HEADER BAGS (PP, PE, PVC), PEELABLE FILMS IN PA/PE, LAMINATES INCLUDING ALUMINUM LAMINATES
SEALING LENGTH	UNICA 610 VV -610 MM / UNICA 810 VV -810 MM UNICA 1010 VV - 1010 MM / UNICA 1210 VV - 1210 MM
SEALING HEIGHT	8 MM
KIND OF SEALING	FLAT SEALING - DOUBLE SEALING BAR
ARCHITECTURE HARDWARE	ROPEX RES 5009 + GANDUS EMBEDDED BOARD + HMI COLOUR TOUCH SCREEN 7"
EXTERNAL CONNECTIONS	1 RJ45 (ETHERNET) PORT, 1 USB PORT, 1 RS232 PORT
CYCLE START COMMAND	VIA ELECTRIC PEDAL
SOFTWARE LOGIC	INTUITIVE ICON-BASED MENU
FUNCTIONING	ELECTRIC / PNEUMATIC
VACUUM SYSTEM	VENTURI AIR SUCTION SYSTEM
VACUUM / GAS FLUSHING	SUCTION NOZZLE HANDLING BY MOTOR WITH ENCODER SINGLE OR DOUBLE SUCTION NOZZLE PLACEMENT POSSIBILITY OF SUCTION / GAS FLUSHING IN RETRACTION UP TO 6 SUCTION/FLUSHING CYCLES
WORKING CYCLES	SEALING; VACUUM AND/OR GAS FLUSHING + SEALING; VACUUM AND/OR GAS FLUSHING
CONSTRUCTION	AISI 304 STAINLESS STEEL AND ALUMINIUM - AISI 304 STAINLESS STEEL FRAME AISI 316L STAINLESS STEEL SUCTION NOZZLE
POWER	230 V – 1PH – 50/60Hz; 115 V – 1PH – 50/60Hz
MAX POWER CONSUMPTION	UNICA 610 -1400W/UNICA 810 -1800W; UNICA 1010 - 2100W;UNICA 1210 - 2400W
PNEUMATIC	0.6 MPa (6 BAR)
POWER GAS	MAX. 0.1 MPa (1 BAR)
ACOUSTIC EMISSION LEVEL	SUCTION/FLUSHING OFF: < 70 dB(A); SUCTION/FLUSHING ON: ≤ 85 dB(A)
PACKAGING STANDARD	ISO 11607-2:2020 / ISO/TS 16775 / EN 868-5:2019 / DIN 58953-7
DIMENSIONS WxDxH	UNICA 610 VV -730x600x280 MM; UNICA 810 VV -930x600x280 MM UNICA 1010 VV - 1130x600x280 MM; UNICA 1210 VV - 1230x600x280 MM
WEIGHT (WITHOUT ACCESSORIES)	UNICA 610 VV -57 Kg / UNICA VV 810 -60 Kg UNICA 1010 VV - 63 Kg / UNICA VV 1210 - 65 Kg

E&OE
TECHNICAL MODIFICATIONS RESERVED 02/2026

GANDUS UNICA VV

VALIDATABLE PNEUMATIC IMPULSE SEALER WITH VACUUM/GAS FLUSHING OPTION

TOP PERFORMANCE IN LIFE SCIENCE

TECHNICAL FEATURES

MACHINE SETTINGS	HMI REMOTE ACCESS AND CONTROL VIA VNC DATA EXCHANGE IN/OUT VIA MODBUS TCP/IP PROTOCOL	
RECIPES	NUMBER NAME	64 RECIPES 20 ALPHANUMERIC CHARACTERS
OPERATORS	NUMBER NAME	40 OPERATOR NAMES WITH ADJUSTABLE ACCESS LEVELS AND PASSWORDS 20 ALPHANUMERIC CHARACTERS
BATCH	NUMBER NAME	40 ALPHANUMERIC BATCH CODES 20 ALPHANUMERIC CHARACTERS
RECIPES / OPERATORS / BATCH	SAVINGS	VIA HMI IN/OUT VIA LAN AND MODBUS TCP/IP COMMUNICATION PROTOCOL IN/OUT THROUGH USB PENDRIVE
PROCESS PARAMETERS	VACUUM TIME ADJUSTMENT RANGE	0 – 100 SEC.
	DISCHARGE TIME DEL GAS ADJUSTMENT RANGE	0 – 100 SEC.
	NOZZLE POSITION ADJUSTMENT RANGE	0 – 150 MM
	SEALING TEMPERATURE RANGE	40 – 220 °C +/- 5 °C
	TOLERANCE RANGE	
	SEALING FORCE RANGE	750 – 1050 N
	SEALING TIME RANGE	0 – 20 s
WORK CYCLE COUNTER	COOLING RANGE	40 – 220 °C
	MODE	INCREASING AFTER COUNTING SETTING DECREASING AFTER COUNTING SETTING UNLIMITED STOP AFTER COUNTING RESTART AFTER COUNTING

E&OE
TECHNICAL MODIFICATIONS RESERVED 02/2026

GANDUS UNICA VV

VALIDATABLE PNEUMATIC IMPULSE SEALER WITH VACUUM/GAS FLUSHING OPTION

TOP PERFORMANCE IN LIFE SCIENCE

TECHNICAL FEATURES

BUZZER	MODE	GENERAL SOUNDS OR ALARM SOUNDS ONLY
LANGUAGE	MODE	MULTILANGUAGE MENU (ITALIAN, ENGLISH, OTHER LANGUAGES AVAILABLE)
CALIBRATION	CALIBRATION	SEALING TEMPERATURE
VALIDATION & TRACEABILITY	PARAMETERS CONTROL (STOP WITH ALARM)	SEALING TEMPERATURE SEALING TIME SEALING FORCE POWER AIR PRESSURE TRACEABILITY ANOMALIES DIAGNOSTIC ANOMALIES
ADJUSTABLE PARAMETERS	ON BOARD USB PEN DRIVE EXTERNAL NETWORK	MACHINE ID SEALING TEMPERATURE SEALING TIME SEALING FORCE COOLING TEMPERATURE OPERATORE (USER) BATCH DATE HOUR POUCH NUMBER FIRMWARE AND SOFTWARE VERSIONS ERROR
MACHINE LOCK FUNCTIONS	LOGIN LEVELS	2 GENERAL ACCESS LEVELS WITH PASSWORD LOGIN WITH BARCODE SCANNER (OPTION)
	MACHINE LOCK/UNLOCK	AVAILABLE ACCESS LEVELS
	ALARMS HISTORY	DATE/HOUR ALARM CODES/ALARM DESCRIPTION
MACHINE FUNCTIONS	COUNTERS	MACHINE GENERAL COUNTERS AND MAINTENANCE ALARM

E&OE
TECHNICAL MODIFICATIONS RESERVED 02/2026

GANDUS UNICA VV

VALIDATABLE PNEUMATIC IMPULSE SEALER WITH VACUUM/GAS FLUSHING OPTION

TOP PERFORMANCE IN LIFE SCIENCE

CONFORMITIES

DIRECTIVES	2006/42/CE 2014/30/UE 2014/35/UE 2015/863/EU
REFERENCES	UNI EN ISO 11607-2 UNI EN 868-5 EN ISO TS 16775 DIN-58953 7 DIRECTIVES 2006/42/EC-2014/30/UE-2014/35/UE UNI/TR 11408 STERILIZATION GUIDELINES-MEMO 5 EU GMP ANNEX 1: MANUFACTURE OF STERILE MEDICINAL PRODUCTS PRODUCED IN A UNI EN ISO 9001:2015 QUALITY SYSTEM CERTIFIED COMPANY

ACCESSORIES

FLOOR STAND	AISI 304 STAINLESS STEEL AND ALUMINIUM STRUCTURE, MOTORIZED, ADJUSTABLE HEIGHT AND INCLINATION, WHEELED
HORIZONTAL WORKING TABLE	ADJUSTABLE IN HEIGHT HORIZONTAL WORKING TABLE – AVAILABLE ONLY WITH FLOOR STAND
INCLINED WORKING TABLE	ADJUSTABLE IN INCLINATION WORKING TABLE – AVAILABLE ONLY WITH FLOOR STAND
BAG STRETCHER	OPEN MOUTH BAG STRETCHER
VACUUM SENSOR	VACUUM PRESSURE VISUALIZATION
CUTTING DEVICE	BAG TRIMMER
PRINTING DEVICE	LABEL PRINTER
SCANNER	BARCODE SCANNER
VALIDATION SERVICES	IQ/OQ PEEL TEST DYE TEST SEAL CHECK CALIBRATION
NEW HARDWARE AND SOFTWARE IMPLEMENTATIONS (OPTIONAL UPON REQUEST)	AUDIT TRAIL OPTIONAL VACUUM SENSOR WITH DUAL OPERATING MODES: TIME SETTING OR VACUUM LEVEL SETTING SKIP FUNCTION FOR THE VACUUM AND/OR GAS INJECTION PHASE COMMUNICATION STANDARD: OPC-UA SERVER

E&OE
TECHNICAL MODIFICATIONS RESERVED 02/2026